

FIXING IN ACCORDANCE WITH THE MANUFACTURERS
PRINTED INSTRUCTIONS, BS5534 PART 1 2014,
BS8000 PART 6 2013 AND H62/210 AND 275

SLATING AS STANDARD EAVES DETAIL

CODE 5 LEAD APRON FLASHING
FIXING IN ACCORDANCE WITH THE MANUFACTURERS
PRINTED INSTRUCTIONS, BS EN 12588:2006

LAYER BOARDS

TILTING FILLET

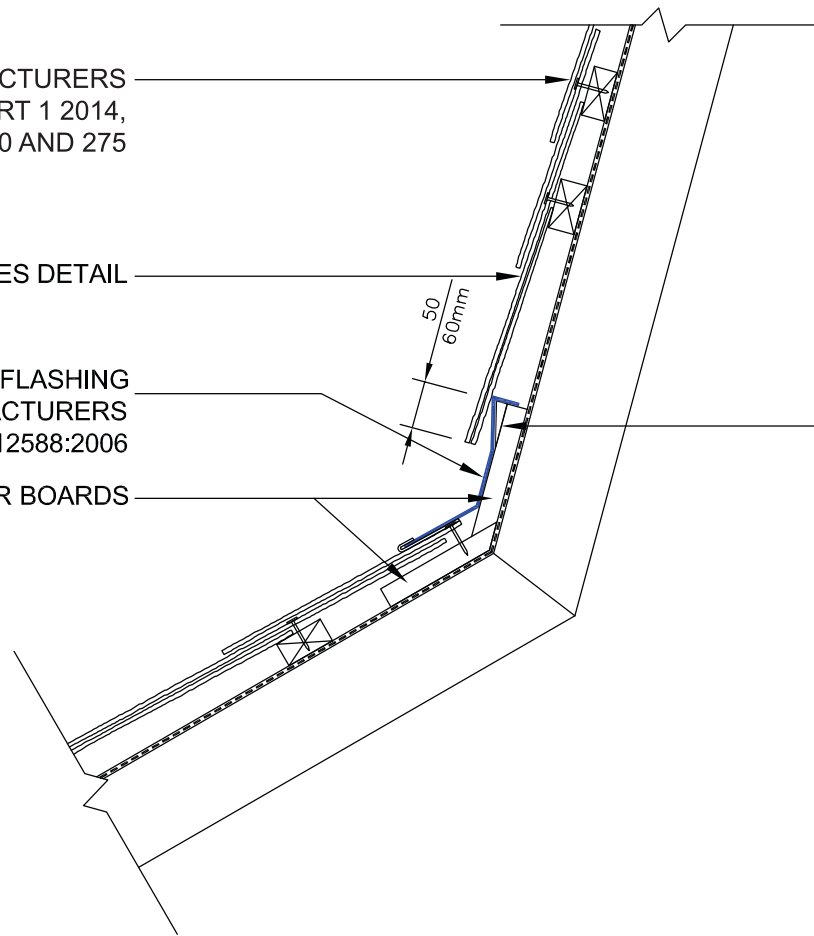

1. Complete slating lower slope as for standard roof upper edge.
2. Fix layer boards to the rafters at the intersection of the two roof slopes, equal in thickness to the battens.
3. Fix tilting fillet to the top edge of the upper layer board, equal in thickness to the battens.
4. Fix code 5 lead apron flashing over the tilting fillet and dress down over the heads of the slate below by at least 150mm. Fix copper straps 300 - 500mm centres.
5. Slate and batten upper slope as standard eaves, with the bottom course projecting below tilting fillet by 50 to 60mm

SSQ NATURAL SLATE
TYPICAL CHANGE OF ROOF PITCH DETAIL
500X250 DEL CARMEN, ULTRA GRADE (NATURAL SLATE)
DRG 010