

RIVERSTONE CLADDING FIXING GUIDE

FIXING INSTRUCTIONS

Tools Required for Installation

- Castellated trowel
- Spirit Level
- Tape Measure
- Adhesive – Stone/slate
- Riverstone Phyllite
- Mitred Corner Riverstone Phyllite

Measuring of External Walls

Before fitting Riverstone Phyllite to the walls, you will need to measure the length and width of your exterior to get the right amount of material for your walls. You will also need to take extra measurements of the space around windows and doors, for corner pieces.

Alternatively, you can send scaled architectural elevation drawings to technical@ssq.co.uk and we will provide an estimate. Riverstone Phyllite can be installed up to a maximum height of 5.5m using an adhesive.

Riverstone Width	Max Length	Max area/pc (m2)	Mechanical Fixing Required Above
100mm	500mm	0.05	5.5 m
150mm	500mm	0.075	5.5 m
200mm	500mm	0.1	5.5 m
250mm	600mm	0.125	3.0 m
300mm	600mm	0.15	3.0 m

Checking the Substrate

Ensure your external walls are in a suitable condition for the cladding.

Good preparation is key to the success of any successful natural stone installation. Walls to be cladded should be constructed using concrete blocks and built on top of strong concrete foundations. Walls should also be flat and free of any protruding mortar. If possible, try and design the wall to dimensions that minimise the number of cuts to be made to the cladding. Uneven walls will make installation of Riverstone cladding difficult and will result in an uneven surface finish to the cladding.

Chips

Natural Stone can contain small chips which is an unavoidable part of the production process and whilst as much care as possible is taken with handling, packaging, and quality control some pieces may contain small chips. Most chips will be virtually undetectable once the stone is installed and will not detract from the appearance of the finished project. During the sorting process, cladding with chips should be set aside wherever possible to be used for cuts or in less visible areas.

Applying the Cladding Adhesive and Slates

The below fixing method has been given for guidance only, please seek fixing advice from the independent adhesive manufacturer before installation.

Preparation

Prior to fixing the first course of cladding to the wall you should fix a level timber batten across the length of the wall. The top of the timber batten should be set at the same height as the underside of the first course of cladding. This is done to prevent vertical migration of the cladding before the adhesive has had a chance to set.

Brickwork or Blockwork

Cladding should be fixed to the wall using a flexible, setting exterior adhesive. Using a tiling trowel, evenly butter the surface of the wall and the back of the cladding stone with the adhesive. Firmly press the stone to the wall. Check that the cladding is horizontally level using a spirit level. Using a trowel, scrape off any excess adhesive.

Ensure your mitred corner slates line up at both the external and internal corners including at the recess around windows and doors.

Install the remainder of the cladding as described previously. Regularly check the levels of the cladding using a spirit level. Small plastic packers may sometime be required to maintain an even level of cladding across the courses.

Adhesive spills are a common occurrence when installing natural stone cladding. Always keep a bucket of clean water and a cloth close to hand and remove any spills immediately.

Cutting

Should there be a need to cut to size then, this operation should be carried out using a wet bed, diamond bladed table saw. Avoid cutting with an abrasive disc cutter as this will cause dry dust.

Eye protection, a face dust mask and gloves should be worn.

Adhesives

Ardex info@ardex.co.uk (Ardex X7G with E90 external additive has been tested by SSQ)

Bal info@building-adhesives.com

Fire Performance

Riverstone Phyllite is a non-combustible covering.

Thermal U-value

The U-value of Natural Slate has been calculated to 1.49.

BASIC DIAGRAM

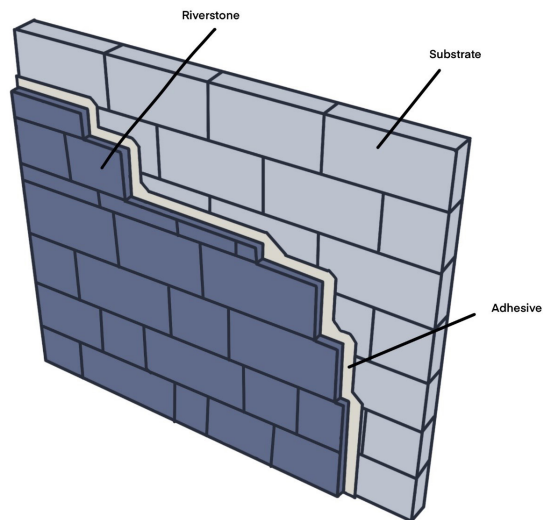

COMBINATION EXAMPLES

100 cm

90 cm

80 cm

70 cm

60 cm

50 cm

40 cm

30 cm

20 cm

10 cm

0 cm

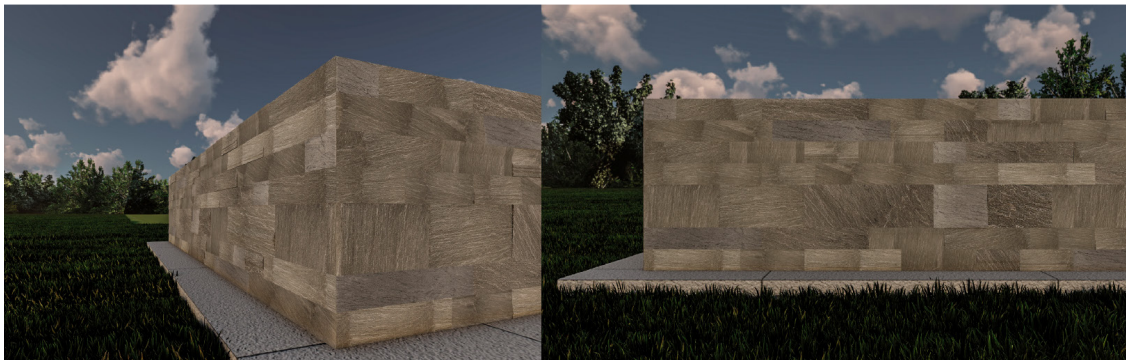
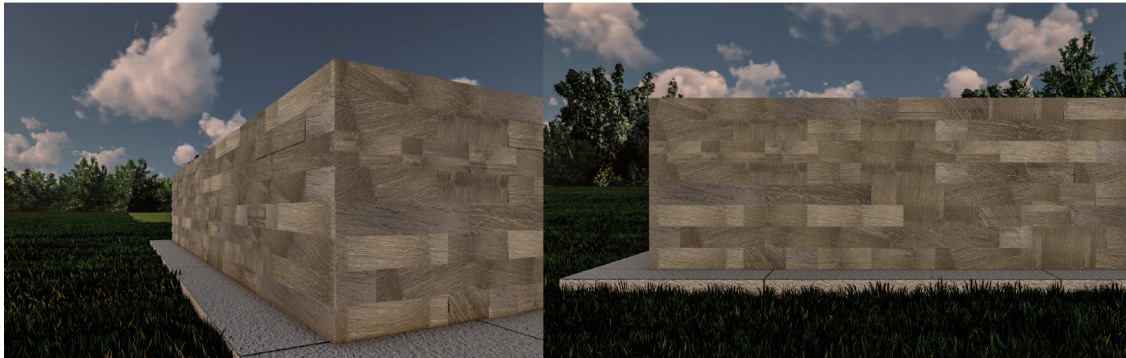

COMBINATION EXAMPLES

